

CASTLE

STEP-BY-STEP 



SUPPLIES



Hand Saw



4 short screws



Screwdriver



6 long screws



1 bolt



1 nut

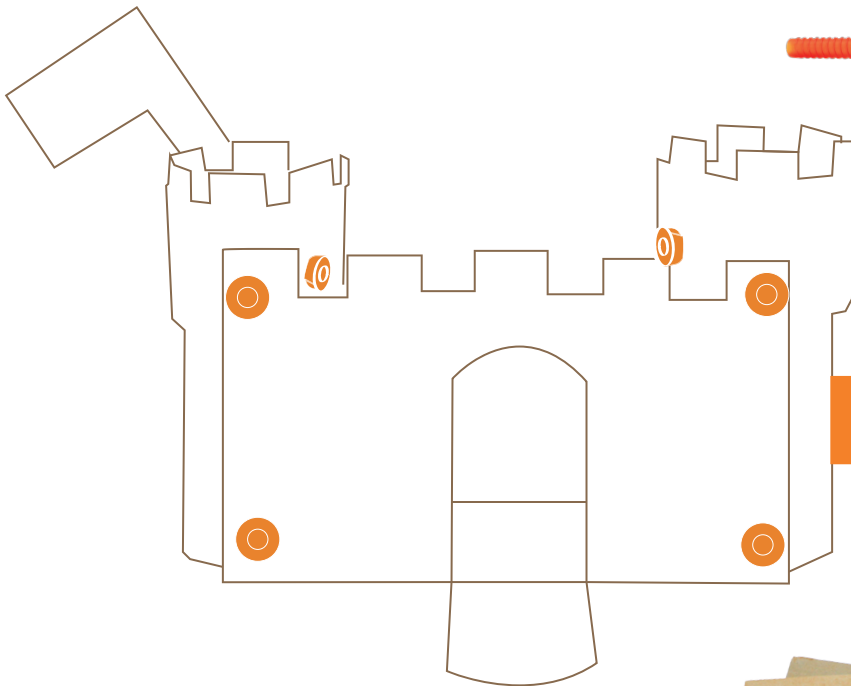

Lets build a castle!

STEP 1

Gather cardboard!



STEP 2

Draw front of castle.

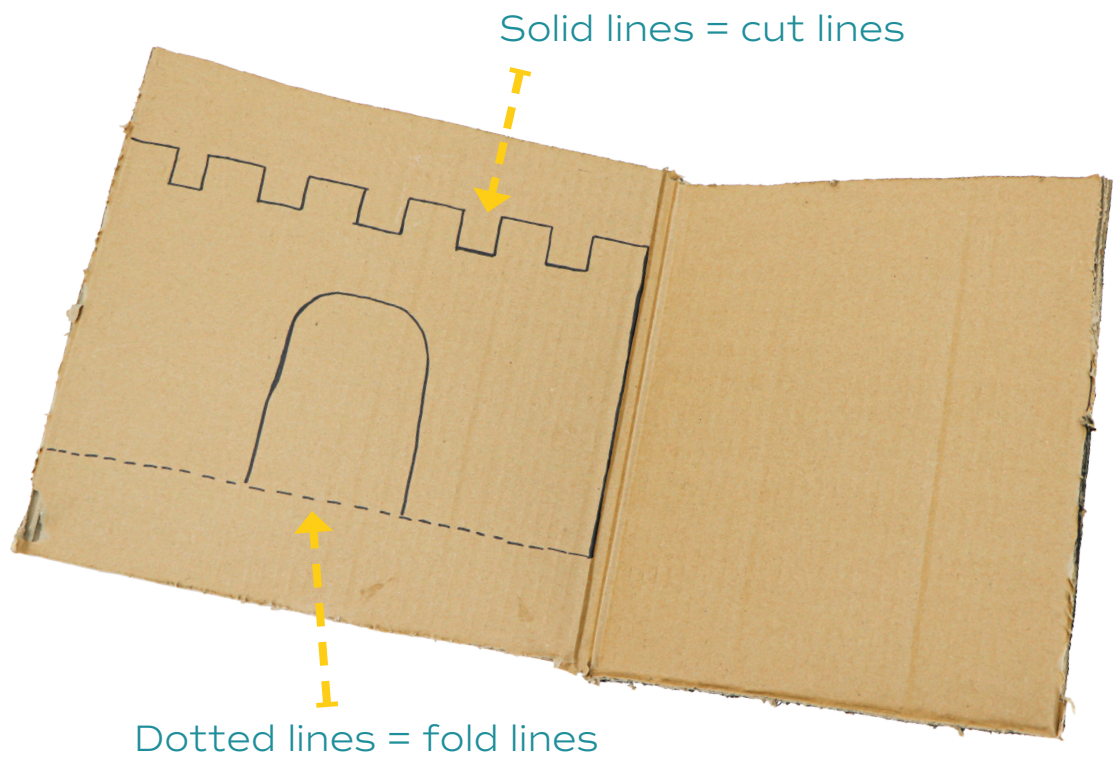

STEP 3

Cut along solid lines.

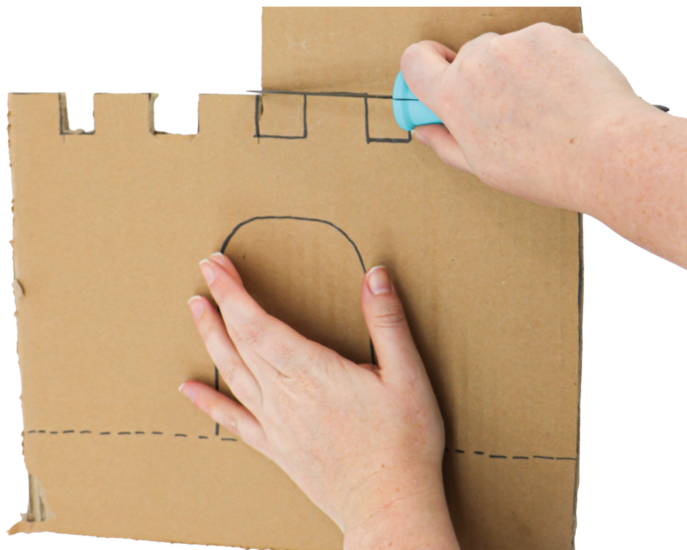

Swift Hand Saw

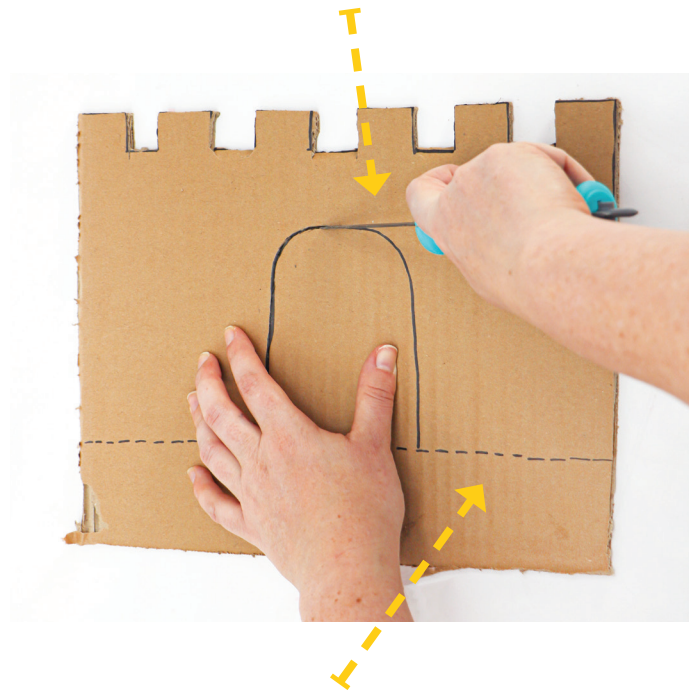

Don't cut the fold lines!



CASTLE STEP-BY-STEP

STEP 4

Fold dotted lines.

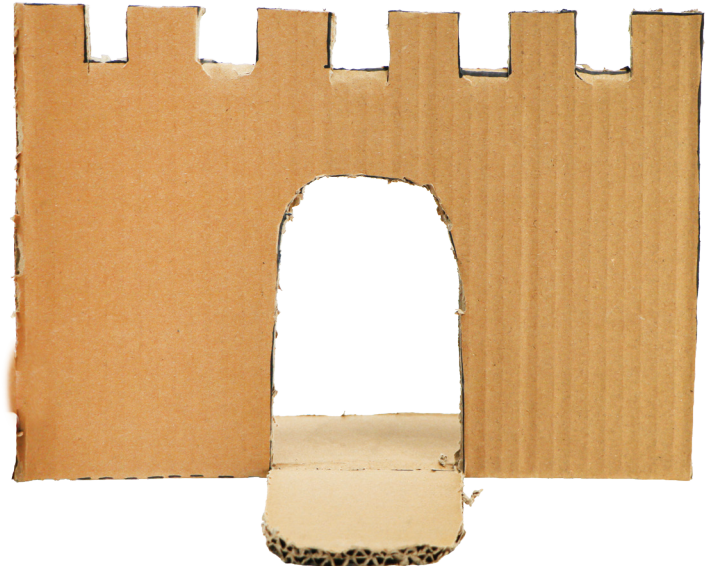

STEP 5

Build two towers for castle.



Roll cardboard



Use screwdriver to
poke hole



Connect with 4
short screws
2 for each tower



CASTLE STEP-BY-STEP

STEP 6

Make two toppers for castle towers.

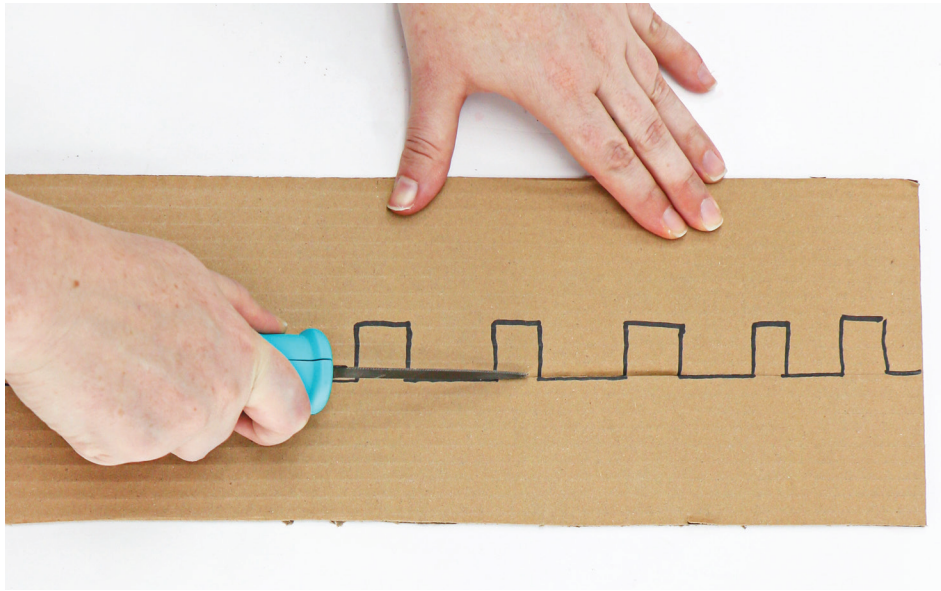

STEP 7

Attach toppers to towers.



Connect with 2
long screws
1 for each tower

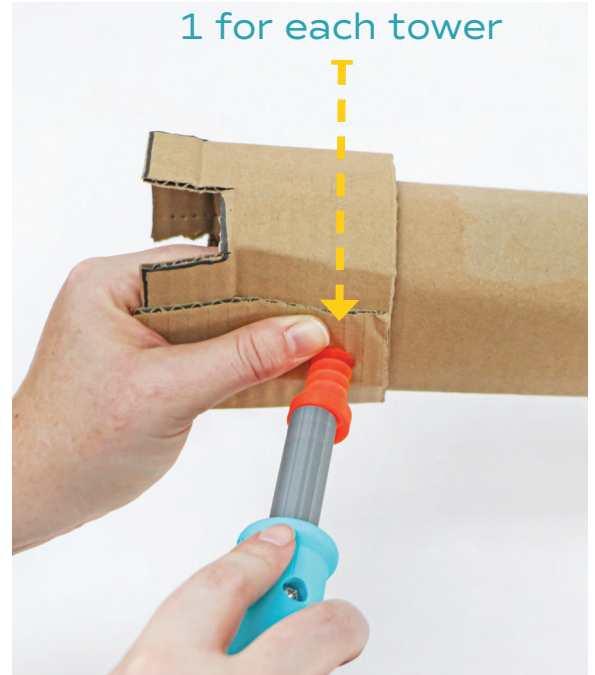

STEP 8

Attach towers to front of castle.

Connect with 4
long screws
2 for each tower

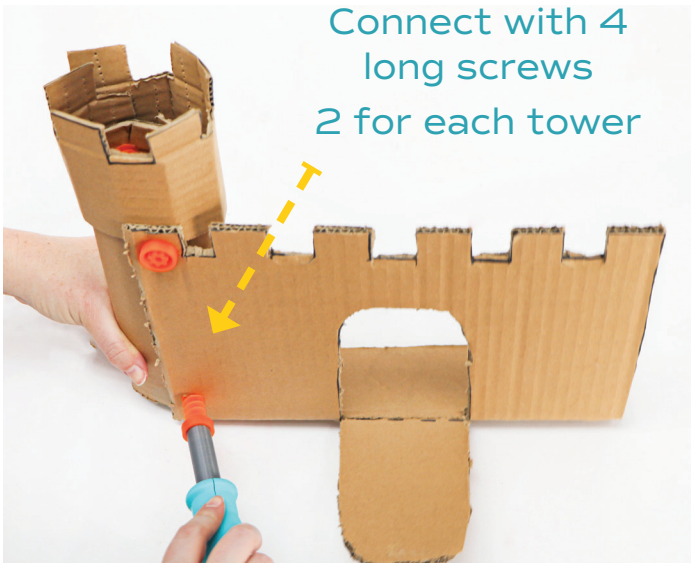

CASTLE STEP-BY-STEP

STEP 9

Make flag for castle.

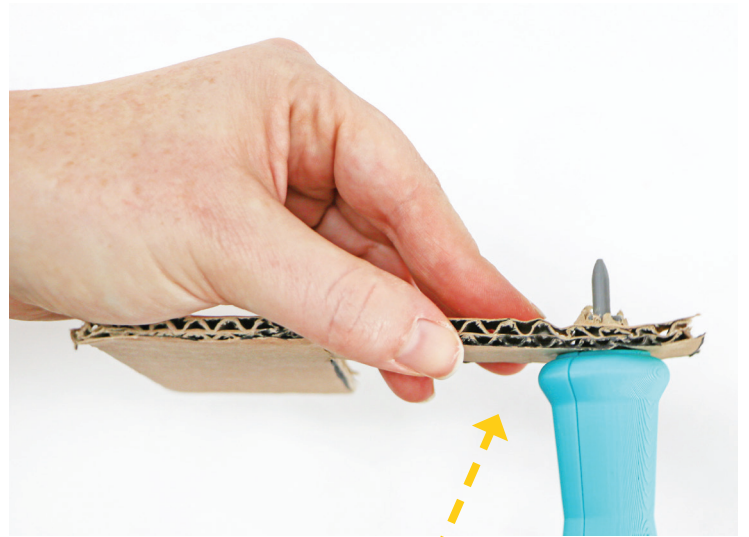
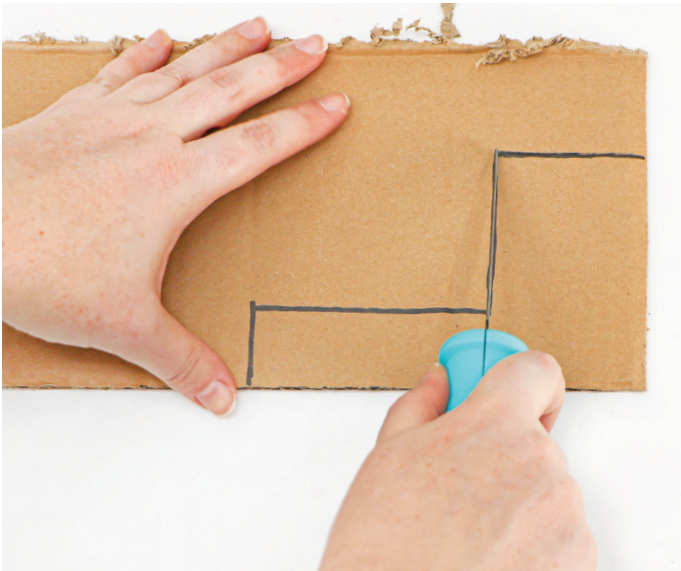

Twist and push
to make bolt hole

STEP 10

Attach the flag to the tower.

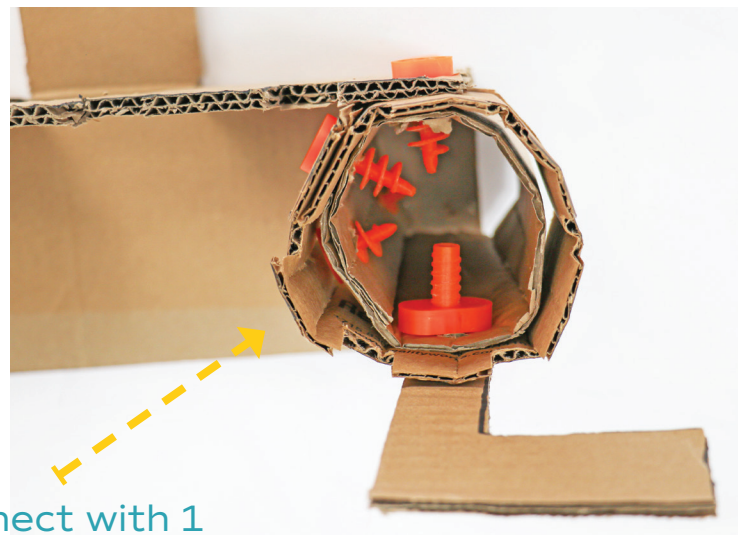
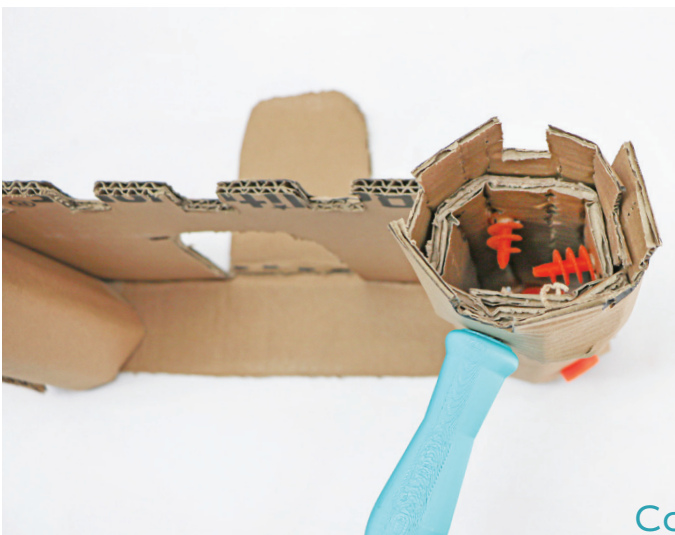

Connect with 1
bolt and 1 nut



CASTLE STEP-BY-STEP

STEP 11

Your castle is complete!



NICE WORK!

Time to decorate however you like!

What will you create?



www.crexo.com/swift

©2026 Swift Cardboard Creations.
All rights reserved.

